



27 Sidmouth Avenue, Westcliff-On-Sea

Westcliff-On-Sea

Guide Price **£275,000**



27 Sidmouth Avenue

Westcliff-On-Sea, Westcliff-On-Sea

Charming 2-bed semi-detached house in a well-connected area. Open-plan kitchen/dining, spacious bedrooms, and 45ft garden with outbuilding. Close to school, shops & transport links. Ideal for first-time buyers or downsizers.

Contact us for viewing.

Council Tax band: B

Tenure: Freehold

EPC Energy Efficiency Rating: D

EPC Environmental Impact Rating: D

27 Sidmouth Avenue

Westcliff-On-Sea, Westcliff-On-Sea

Charming 2-bed semi-detached house in a well-connected area. Open-plan kitchen/dining, spacious bedrooms, and 45ft garden with outbuilding. Close to school, shops & transport links. Ideal for first-time buyers or downsizers. Contact us for viewing.

Council Tax band: B

Tenure: Freehold

EPC Energy Efficiency Rating: D

EPC Environmental Impact Rating: D

- 2 Double bedrooms
- 45ft Garden
- Outbuilding that is used as a utility and shed, but could be converted
- Driveway
- Open plan Kitchen/dining room
- 1-minute walk to Prince Avenue Primary School
- 5-minute walk to local shops
- 15-minute walk to Southend Airport and Railway Station - taking you to London Liverpool Street in around an hour
- Guide Price - £275,000 - £300,000





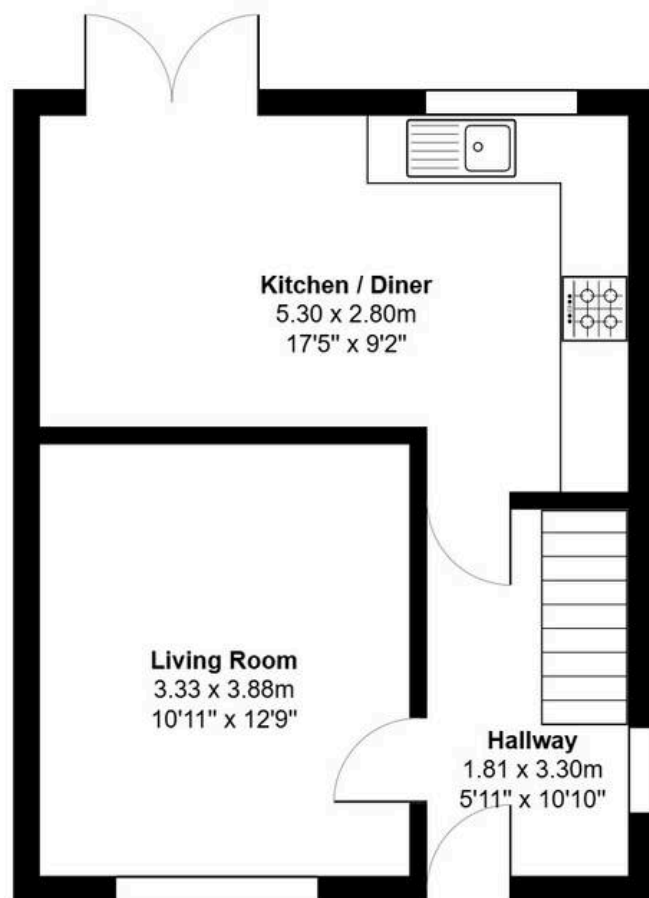

Ground Floor
Area: 36.3 m² ... 390 ft²

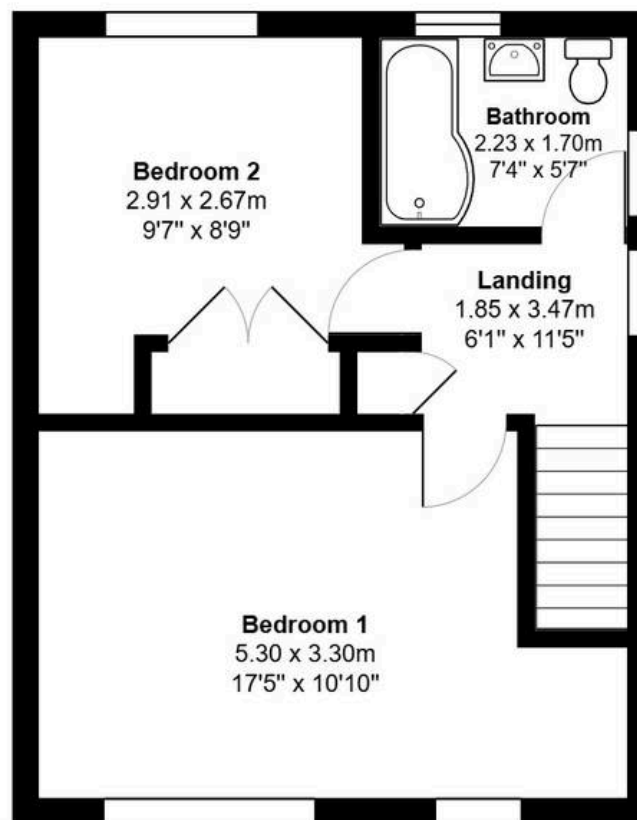

1st Floor
Area: 36.3 m² ... 390 ft²

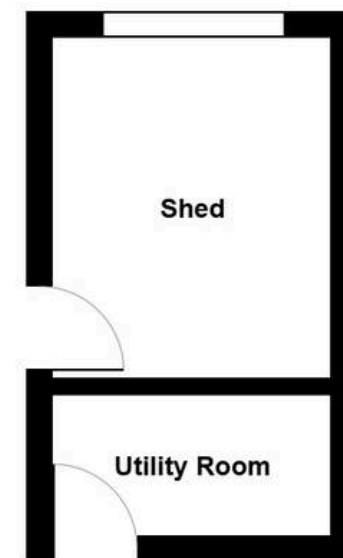

Outbuilding
Area: 11.2 m² ... 121 ft²

Total Area: 83.7 m² ... 901 ft²

All measurements are approximate and for display purposes only



You can include any text here. The text can be modified upon generating your brochure.

